



**ISLAND COUNTY
PLANNING & COMMUNITY DEVELOPMENT**

PHONE: (360) 679-7339 ■ from Camano (360) 629-4522, Ext. 7339 ■ from S. Whidbey (360) 321-5111,
Ext. 7339 FAX: (360) 679-7306 ■ 1 NE 6th Street, P. O. Box 5000, Coupeville, WA 98239-5000
Internet Home Page: <http://www.islandcountywa.gov/planning/>

**AMENDMENT TO STAFF REPORT & DECISION
SHORELINE EXEMPTION- TYPE I
183/16 SHE – SEAHORSE SIESTA CLUB
REMOVE EXISTING BARGE/BULKHEAD & RESTORE NEARSHORE HABITAT**

I – AMENDMENT

The approval for Shoreline Exemption 183/16 SHE is hereby amended to authorize the removal of the existing barge, bulkhead and fill with the amended proposal to include two proposed drift sills (projecting approximately 11ft and 16ft from the toe of the slope) with the addition of beach nourishment. The original proposal that was approved included 65ft of structural stabilization (rockery wall). The amended design does not include the hard armoring of a rockery wall and the proposed drift cell structures will provide better protection for the beach access path, reduce bluff erosion and will preserve the existing shore form.

This amendment does not modify any findings or Conditions of Approval contained within 183/16 SHE. Any further modifications may require a new shoreline permit.

II – APPEALS

Island County Code does not contain a provision for administrative appeal of Type I permits if approved. Any challenge to permit conditions sought by the applicant may be filed under Washington's Land Use Petition Act (LUPA), Chapter 36.70C RCW.

SIGNED THIS 24th DAY OF JUNE 2019



Janet Wright, Senior Planner
Island County Planning & Community Development

Enclosed:

- Revised Site plan prepared by Coastal Geologic Services dated 6/14/19

K:\IslandCo\19-022_SeahorseSiesta\19-022_SeahorseSiesta_CGS.dwg

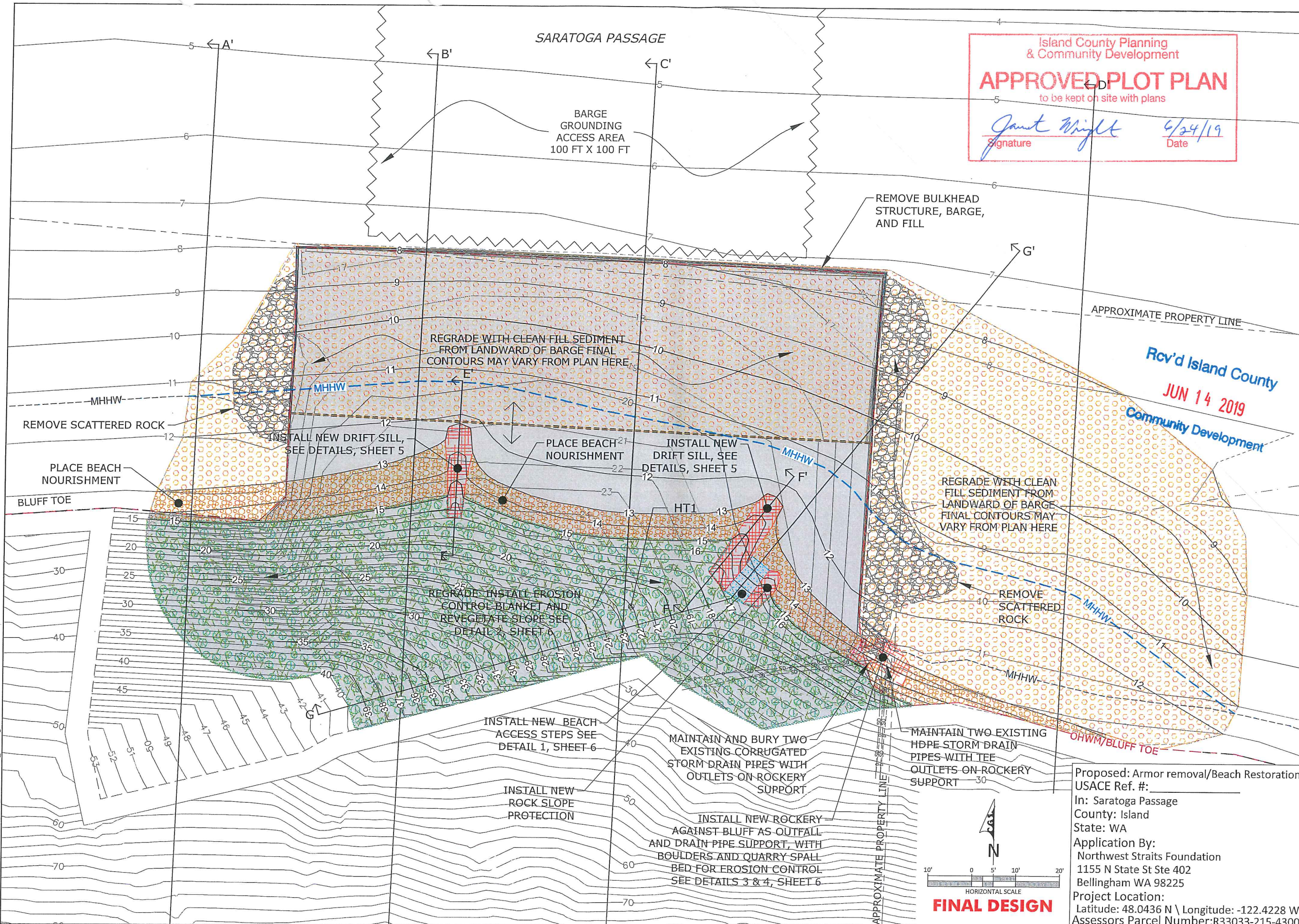

Island County Planning
& Community Development
APPROVED PLOT PLAN
to be kept on site with plans
Janet Wright 6/24/19
Signature Date

COASTAL GEOLOGIC SERVICES
1711 Ellis St, Suite 103
Bellingham, WA 98225
360-647-1845 - coastalgeo.com

REVISIONS	
DRAWN BY:	ADT
DESIGNED BY:	WC
CHECKED BY:	JWJ
DATE SURVEYED:	12/5/2014
SURVEYED BY:	JWJ/ADT

SEAHORSE SIESTA BULKHEAD REMOVAL
PROPOSED CONDITIONS
SITE GRADING PLAN
NORTHWEST STRAITS FOUNDATION



MLLW = 0.00'
MHHW = 11.26'

SCALE: AS SHOWN
DATE: 6/4/2019
SHEET:

3

OF:6

Proposed: Armor removal/Beach Restoration
USACE Ref. #:
In: Saratoga Passage
County: Island
State: WA
Application By:
Northwest Straits Foundation
1155 N State St Ste 402
Bellingham WA 98225
Project Location:
Latitude: 48.0436 N \ Longitude: -122.4228 W
Assessors Parcel Number: R33033-215-4300

ISLAND COUNTY
PLANNING & COMMUNITY DEVELOPMENT
PO BOX 5000
COUPEVILLE, WA 98239-5000

AFFIDAVIT OF MAILING

I, Janet Wright, holding the position of Senior Planner for the Island County Planning and Community Development, do hereby depose and swear I did on the 24th day of June, 2019, delivered to the County mailroom for delivery to the U.S. Postal Service and e-mailed a copy of the staff decision, in the matter referenced as 183/16 SHE – Seahorse Siesta Beach Club to the persons listed below:



Signature

Lisa Kaufman,
Northwest Straits Marine Conservation Foundation
1155 North State Street, Suite 402
Bellingham, WA 98225

Celia Michael, President
Seahorse Siesta Beach Club
P.O. Box 781
Langley, WA 98260